

FORMDEX PLUS

CONCRETE WATERPROOFING & PROTECTION

Formdex Plus is a special blend of cement, quartz sand and multiple activating chemicals in powder form for the permanent protection of concrete against water penetration.

The compound by the pressure of osmosis will penetrate deep into the capillary tracts of the concrete and reacts with moisture and free lime forming crystals that will completely seal the capillaries, pores and minor shrinkage cracks, making it impenetrable to water under high pressure.

In the absence of moisture, the Formdex Plus components will lie dormant. Should moisture recur at any time, the chemical reaction and sealing process repeats itself automatically. The process works on the active (side exposed to water) or the negative side (side opposite to the water).

1. REGATTA ICON - JAKARTA INDONESIA



Benefits

Waterproofing is permanent, crystals become an integral part of concrete. Crystal growth penetrates deeply into the capillary tracts and seals it completely. Completely effective against high hydrostatic head pressure.

Can be applied from either the positive or negative side. Does not require protection against backfilling or placement of reinforcement steel. Cannot come apart at the seams, tear or puncture. Can be applied to moist or green concrete. Non-toxic, approved for potable water use.

Areas of Usage

Formdex Plus can be applied to all structurally sound concrete - new or old. It may be applied to either the active or negative side of the concrete face.

Application

Slurry Application - applied in one or two coats according to specification by masonry brush or power spray equipment.

Dry Powder Sprinkle - (for horizontal surfaces only). Formdex Plus is distributed in powder form onto lean concrete or into freshly placed concrete once this has reached initial set as according to specification.

Please refer to product data specification for comprehensive application guidelines.

How It Works

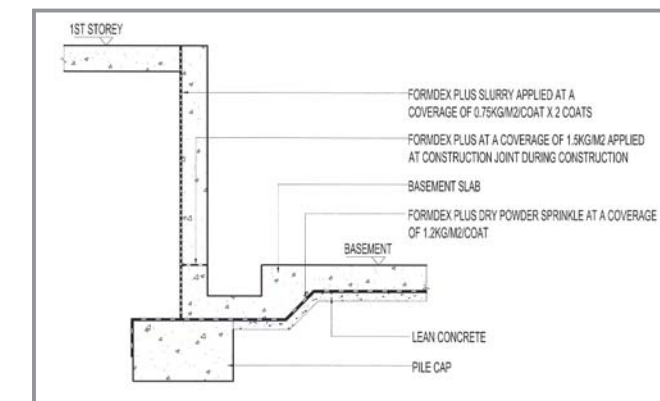
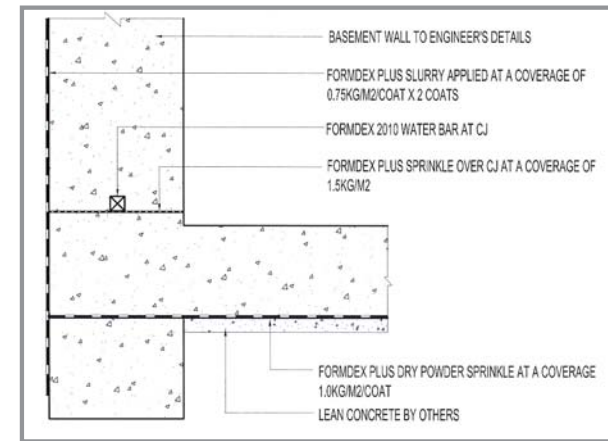
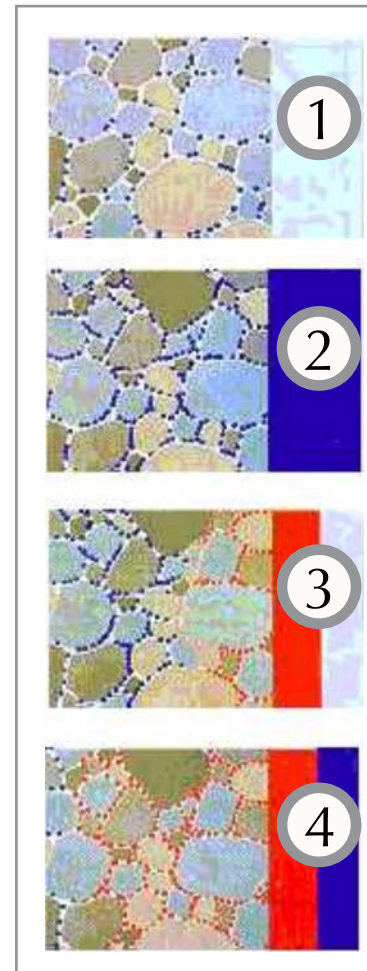

Complete System (for use in conjunction with Formdex Plus)

Formdex 2010 - is a hydrophilic polymer composites waterstop that will slowly expand when in contact with water. It does not expand prematurely and does not absorb water from fresh concrete poured against it. The waterstop is placed in concrete joints and critical areas where water leakage is likely. When in contact with water, the swelling action will cause Formdex 2010 to form itself in the joint, filling cavities and effectively stopping water at high hydrostatic pressure.

Formdex Uni - is a flexible cementitious, two component, polymer modified waterproofing membrane. It is 100% compatible to all masonry substrate. Due to its excellent adhesion and tensile strength, it can be applied as an additional protection around penetrations.

Formdex Seal - is a cementitious ready-mixed surface waterproofer with hydrophobic properties that has excellent resistance to water and moisture. It is used in filling of routed out cracks, patching of form tie-holes and faulty construction joints.

- 1) Section of dry concrete wall showing the natural free lime and moisture in the capillary system.
- 2) Concrete wall exposed to water: The water forced its way into the capillaries.
- 3) After treatment: Formdex Plus penetrates the concrete forming chemical complexes which block the capillaries.
- 4) The concrete is now watertight but still allows water vapour to pass.



1. Measuring of Materials



2. Sprinkling of Formdex Plus



3. Sprinkling prior to casting



4. Mechanical mixing with water



5. Prewatering before application



6. Application is with brush

PROJECTS

MAIOR PROJETS

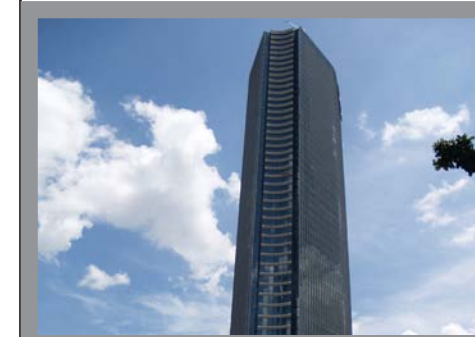

Grand Indonesia - Jakarta Indonesia



Putra Jaya Mosque - KL Malaysia



The Esta - Singapore



WTC MANGGA 2 - Jakarta, Indonesia



The Residences, Changkat - KL Malaysia



Sutramas Condominium - KL Malaysia



Kiarra 1888 Condominium - KL Malaysia

FORMD

Hitchins



EMPORIUM MALL & HOTEL - JAKARTA INDONESIA



TTDI PLAZA - KL, MALAYSIA

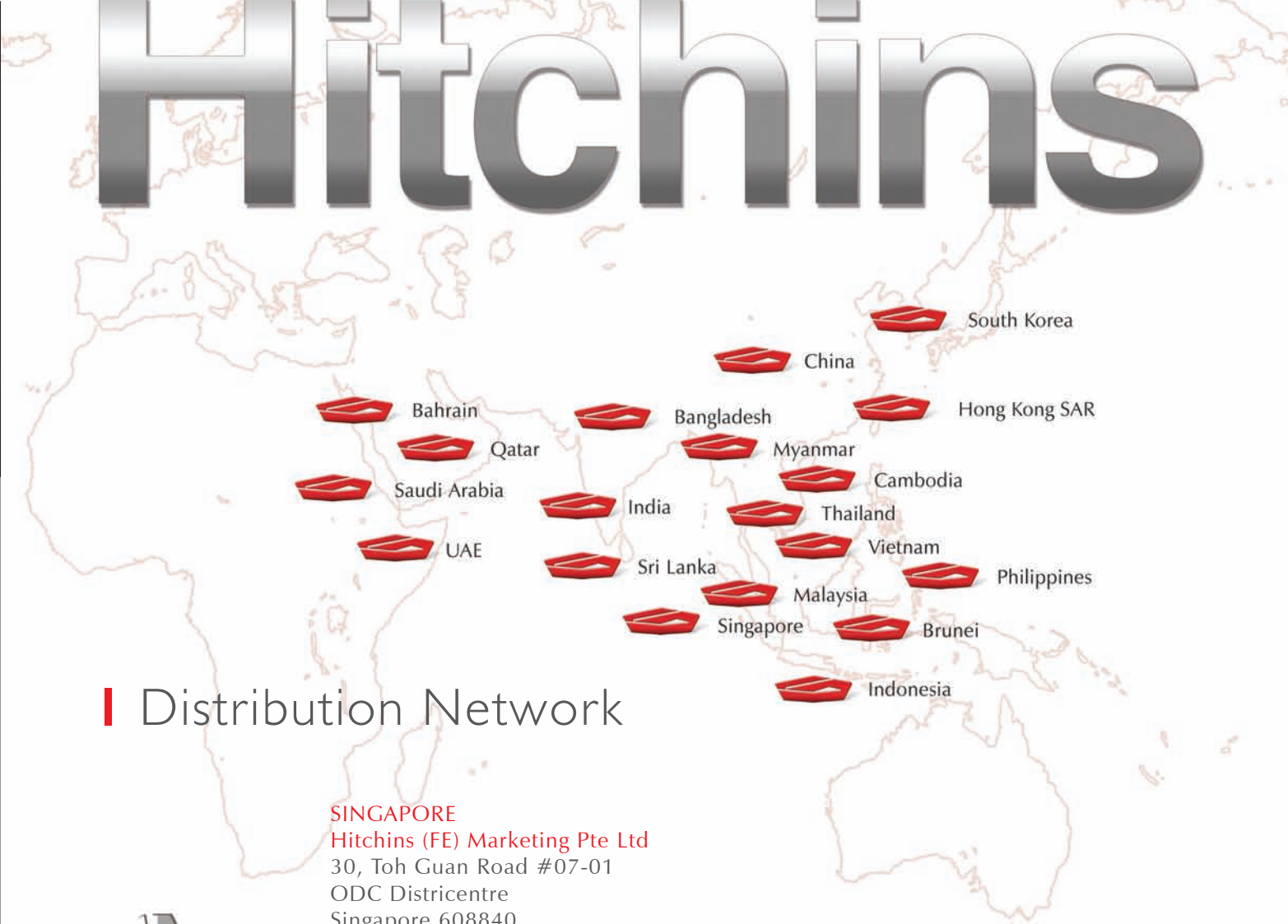

Distribution Network

SINGAPORE

Hitchins (FE) Marketing Pte Ltd
30, Toh Guan Road #07-01
ODC Districentre
Singapore 608840
Telephone: (65) 6861 1177
Facsimile: (65) 6863 4240
Email: hitchins@hitchins.com

MALAYSIA

Hitchins (Malaysia) Sendirian Berhad
No. 26 Jalan 4/10B
Spring Crest Industrial Park 68100 Batu Caves, Selangor, Malaysia
Telephone: (60-3) 6185 8888
Facsimile: (60-3) 6185 0668
Email: hitchins@streamyx.com

CHINA

Shanghai Hitchins Da Sheng Waterproofing Materials Co., Ltd
No. 58, 699 Nong, Bei Qing Gong Lu Hua Cao Zhen, Ming Hang Qu Shanghai P.R.
China Post Code 201107
Telephone: (86-21) 62219815/7/9 Facsimile: (86-21) 6221 9812
Email: samkim@hitchins.com

BRUNEI

Hitchins (Borneo) Sendirian Berhad
P.O. Box 1675
Bandar Seri Begawan 1916
Telephone: (673-2) 652561
Facsimile: (673-2) 652563

WATERPROOFING
& BUILDING PROTECTION

Hitchins Approved Applicator



Hitchins (FE) Marketing Pte Ltd

Tel: (65) 6861 1177 Fax: (65) 6863 4240

Email: hitchins@hitchins.com [Http://www.hitchins.com](http://www.hitchins.com)

FORMDEX PLUS

CONCRETE WATERPROOFING & PROTECTION



WARRANTY INFORMATION

Only Hitchins' trained applicators are approved to undertake all application work. Hitchins products carry a long-term warranty for both materials and workmanship. The warranty is further backed by Hitchins International Fidelity Fund. Please check with our local applicators if this fund is available in your country. For complete warranty and other related information, please contact Hitchins regional offices.

Revision A