

# FORMDEX

CEMENTITIOUS WATERPROOFING SYSTEM



032 002  
Environmentally Friendly Paint/Coating

Formdex is a two component cementitious waterproofing system that offers an effective and permanent waterproofing solution to concrete structures. Formdex is 100% compatible with all masonry structures.

Due to its excellent adhesion, high flexural and tensile strength, it can be applied to both horizontal and vertical surfaces. It is efflorescence free and can be used against active or passive water pressure.

### It comes in 2 parts:

Component A (powder form) consists of Ordinary Portland Cement, graded quartz sand and inorganic additives.

Component B (liquid form) is the polymeric binder, which is essentially a modified styrene acrylic co-polymer that gives the product its excellent resistance against water and alkali.



PAKUBOWONO CONDO - JAKARTA INDONESIA

### Different Types

**Formdex Uniflex** is a heavy duty waterproofing membrane that has excellent flexibility and strength. Hence it is used in situations where movement or cracking of the substrate is occurring or anticipated. Should be used as a concealed system

**Formdex Uni** is a heavy duty waterproofing membrane that seals water, rain, ground water and masonry, concrete, plaster and similar substrates. In addition, its high build nature enables it to absorb shock transmitted through the topping material and allow some flexing between it and the substrate. Should be used as a concealed system.

THOMSON BAPTIST CHURCH - SINGAPORE



### Areas of Usage

- Wet areas
- Swimming pools and water features
- Decks and patios
- Driveways
- Lift pits
- Retaining Walls
- Underground shafts
- Foundation walls and footings

### Application

Prior to application, ensure that the concrete is clean and sound. Damp the substrate without leaving behind puddles of water.

**Areas with surface of low water pressure** (such as wet areas, decks, planters etc):

Apply by roller or brush 2 coats of Formdex at spreading rate of 1.0kg/m<sup>2</sup>/coat. Allow at least 3 hours drying time between each coat. Approximate DFT thickness 1mm.

**Areas with ground or high water pressure** (such as swimming pools, ponds, basement etc):

Apply by roller or brush 3 coats of Formdex at spreading rate of 1.0kg/m<sup>2</sup>/coat. Allow at least 3 hours drying time between each coat. Approximate DFT thickness 1.5mm.

### Detailing

Apply Formdex at 1.0kg/m<sup>2</sup> making certain to dress up at least 150mm from the finished floor or roof level along walls. Immediately roll a layer of fibreglass mat and apply another coat of Formdex at 0.5kg/m<sup>2</sup>

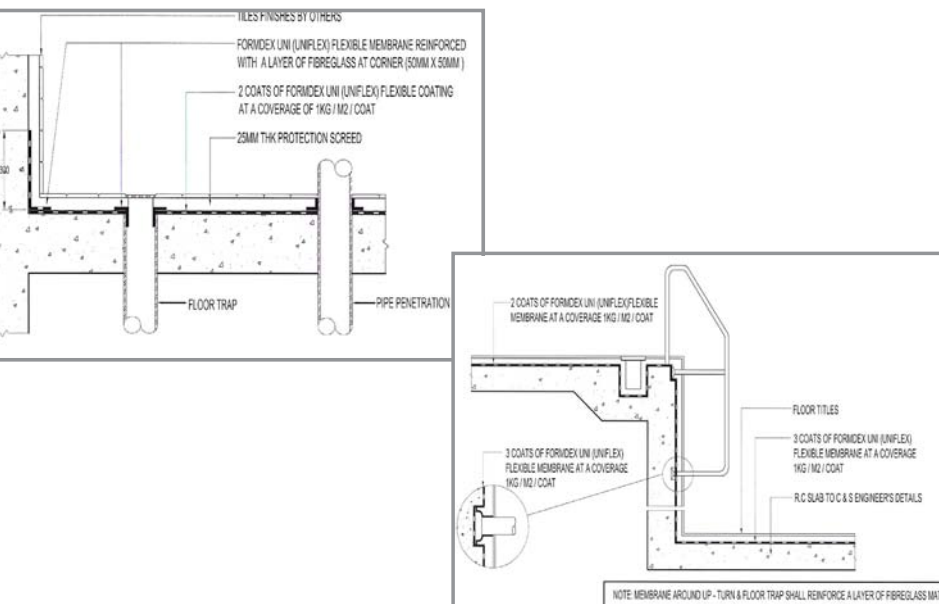

ST JOSEPH SWIMMING POOL COLOMBO, SRI LANKA



### Special Features

- **Wide Compatibility**  
May be applied on brickwood, concrete, stone and similar substrates

- **Excellent adhesion**  
Is 100% compatible to masonry substrate, has excellent adhesion to the substrate it is applied on

- **Flexibility**  
Formdex has high flexibility and can bridge cracks up to 2mm width

- **Easy Application**  
Applied using roller and brush. Can be applied on vertical and horizontal surface and on damp substrate

- **Dries in humid conditions**  
Dries well in humid conditions. Can be applied in enclosed or poorly ventilated conditioning

# PROJECTS

## MAJOR PROJECTS



AXA Building - Pune, India



The Esta - Singapore



Colombo Airport - Colombo, Sri Lanka



Fortuna Hotel - Hanoi, Vietnam



Grand Indonesia - Jakarta Indonesia



Rockwell Center - Manila, Philippines



Hanoi Tower - Hanoi Vietnam



Park Seven Condominium - Malaysia



Newton 18 Condo - Singapore



1. Reinforced with fibreglass



2. Membrane is applied



3. Termination at 300mm height



4. Membrane applied to concrete



5. Membrane applied in 2 coats



6. Membrane applied to 1.8m height

# FORMD

# Hitchins



**Hitchins**  
since 1932



032 002  
Environmentally Friendly Paint/Coating

◀ CHANGI RISE CONDO - SINGAPORE



◀ PATERSON RESIDENCE - SINGAPORE



◀ SUTRAMAS CONDO - KL, MALAYSIA



## Distribution Network

### SINGAPORE

**Hitchins (FE) Marketing Pte Ltd**  
30, Toh Guan Road #07-01  
ODC District Centre  
Singapore 608840  
Telephone: (65) 6861 1177  
Facsimile: (65) 6863 4240  
Email: [hitchins@hitchins.com](mailto:hitchins@hitchins.com)

### MALAYSIA

**Hitchins (Malaysia) Sendirian Berhad**  
No. 26 Jalan 4/10B  
Spring Crest Industrial Park 68100 Batu Caves, Selangor, Malaysia  
Telephone: (60-3) 6185 8888  
Facsimile: (60-3) 6185 0668  
Email: [hitchins@streamyx.com](mailto:hitchins@streamyx.com)

### CHINA

**Shanghai Hitchins Da Sheng Waterproofing Materials Co., Ltd**  
No. 58, 699 Nong, Bei Qing Gong Lu Hua Cao Zhen, Ming Hang Qu Shanghai P.R.  
China Post Code 201107  
Telephone: (86-21) 62219815/7/9 Facsimile: (86-21) 6221 9812  
Email: [samkim@hitchins.com](mailto:samkim@hitchins.com)

### BRUNEI

**Hitchins (Borneo) Sendirian Berhad**  
P.O. Box 1675  
Bandar Seri Begawan 1916  
Telephone: (673-2) 652561  
Facsimile: (673-2) 652563

WATERPROOFING  
& BUILDING PROTECTION

Hitchins Approved Applicator



## Hitchins (FE) Marketing Pte Ltd

Tel: (65) 6861 1177 Fax: (65) 6863 4240

Email: [hitchins@hitchins.com](mailto:hitchins@hitchins.com) [Http://www.hitchins.com](http://www.hitchins.com)

# FORMDEX

## CEMENTITIOUS WATERPROOFING SYSTEM

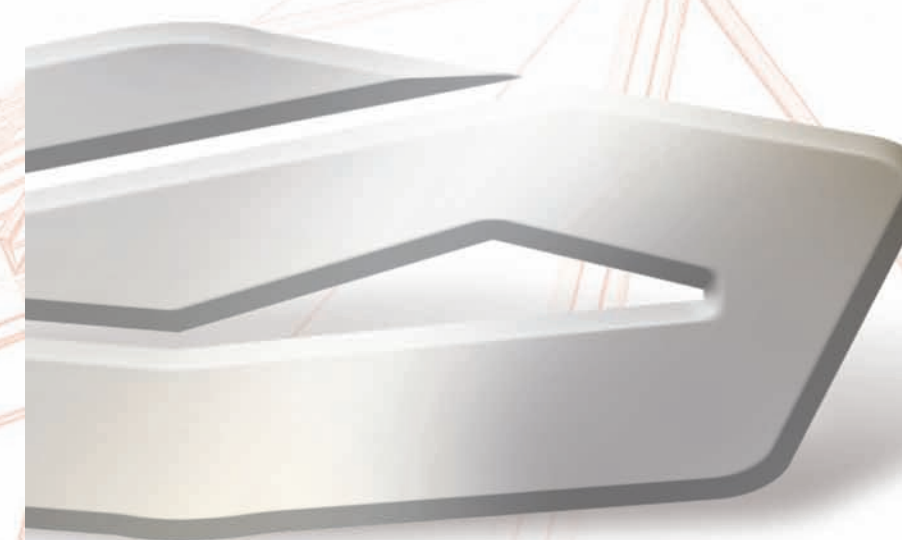

ISO 9001  
BUREAU VERITAS  
Certification



### WARRANTY INFORMATION

Only Hitchins' trained applicators are approved to undertake all application work. Hitchins products carry a long-term warranty for both materials and workmanship. The warranty is further backed by Hitchins International Fidelity Fund. Please check with our local applicators if this fund is available in your country. For complete warranty and other related information, please contact Hitchins regional offices.

Revision A